

STANDARD FEATURES

- 750 lbs. weight capacity
- **IS6™** Instant Steer 6 Wheel Steering
- Side Rails - dual release stainless steel glide & tuck
- Integrated push/pull handles
- Center column design with precision ball bearings
- Quick-Release O₂ Tank Holder (US Patent 7,865,984 B2)
- Dual Trendelenburg assist cylinders (positive/negative - pneumatic)
- Mechanical Level Lock
- Pneumatic assist fowler 600N (135#) force
- Dual side-mounted hydraulic foot pedals
- Brake & Steer activated foot pedals
- Four corner IV pole receptacles
- Four restraint strap positions
- High impact corner bumper
- 8" easy mobility casters
- Latex-free

SPECIFICATIONS

Model Number	7500 ^N	7500 ^W
Weight Capacity	750 lbs. (340 kg)	750 lbs. (340 kg)
Overall Length	83" (211 cm)	83" (211 cm)
Overall Width	29.5" (75 cm)	33.5" (85 cm)
Height Range		
Low	23" (58 cm)	23" (58 cm)
High	32.75" (83 cm)	32.75" (83 cm)
Litter Positioning		
Fowler Backrest	0°-90°	0°-90°
Trendelenburg	+12°	+12°
Reverse Trendelenburg	-7°	-7°
Patient Surface	77" x 27" (196 x 69 cm)	77" x 31" (196 x 77 cm)
Side Rails	14" x 76" (36 x 193 cm)	14" x 76" (36 x 193 cm)
Casters	8" (20 cm)	8" (20 cm)
Warranty *	1 year parts and labor	1 year parts and labor

* 7500 Special Package Warranty (7500-SPEC): 2 year parts and labor.

OPTIONS

Accessory	N	W	Accessory	N	W	Accessory	N	W
X-Ray Board			IV Pole Options:			Pedal Configuration Options:		
Full	750203	750204	Fixed Height	2101	same	Hydraulic Release Pedal ...	750106	same
Partial	750205	750206	Adjustable/Removable ...	5984001	same	Foot-End IS6™ Pedal	750107	same
Mattresses:			Adjustable Attached	750501	750502	Foot-End IS6™ Pedal & Hydraulic Release Pedal	750108	same
3" Standard (black)	5828002	5831002	Fold Down	59175001	same	Additional Options:		
3" Premium (blue)	5850002	5852002	IV Pole Caddy	59163001	same	Storage Bag Hook	750215	same
4" Standard (black)	5829002	5832002	Push/Pull Bar Options:			Paper Roll Holder	5966001	5966003
4" Premium (blue)	5851002	5853002	Push/Pull Handles (CuVerro®) ..	750223	750224	O ₂ Tank Holder (Vertical) ...	5981001	same
4" Pressure Relief	5833002	5834002	Push/Pull Bar (Removable) ..	5985001	5986001	400N (90#) pneumatic assist fowler	750602	same
5" Premium (blue)†	5855002	5856002	Bar Pad	5704001	5705001	Head/Foot Extension	5996001	same
† Special order only.			Chart Holder	5967001	same	Head/Foot 3" Pad	5708001	same
Restraint Straps Options:			Monitor Tray Board	59115001	59116001	Stirrups Set		same
Velcro (pair)	5903001	same	(includes chart holder 5967001)			5910001		same
Buckle (pair)	5904001	same	Knee Flex					
Side Rail Options:			Hand Crank	750201	750202			
CuVerro® Rails	750302	same	Hydraulic	750208	750209			
Rail Pad (pair)	5716001	same						
			Leg Lift	Knee Flex	Trauma			

stretcher series
7500
transport / trauma stretcher



stretcher series
7500
 trauma / transport stretcher

Pedigo's 7500 Series Stretcher allows for the transfer of patients easily and comfortably with a load capacity up to 750 pounds. Superior stability, mobility, and braking capabilities make the 7500 versatile for all your department needs such as OR, ED, PACU, Patient Transportation, Radiology or Cath Lab.

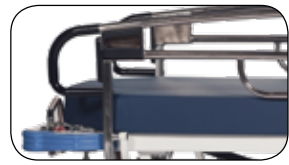

1 RAIL SYSTEM:

Full length stainless steel side rails feature integrated push-pull handles with latch releases located at all four corners of the stretcher. Easy one-handed operation. No hinges, mechanical connections or plastic couplings to trap debris or fluid. Easy to wipe clean and disinfect.



2 O₂ TANK HOLDER:

Pedigo's ergonomic Quick-Release O₂ Tank Holder is side-mounted and conveniently located under the patient surface to reduce caregiver bending. (US Patent 7,865,984 B2)



3 SIX WHEEL STEERING:

The two Instant Steer wheels are centered directly under the chassis for increased control and maneuverability. Dual ball bearing wheels feature a softer wheel tread for improved grip and traction.



4 CENTER COLUMN SUPPORT:

Sturdy steel column with single hydraulic lift cylinder design uses sixteen precision ball-bearings to smoothly raise and lower the patient.



5 HYDRAULIC PEDALS:

Hydraulic foot pedals are located on each side of the stretcher within the patient care zone. Color-coded pedals and function graphics are quickly and easily understood.

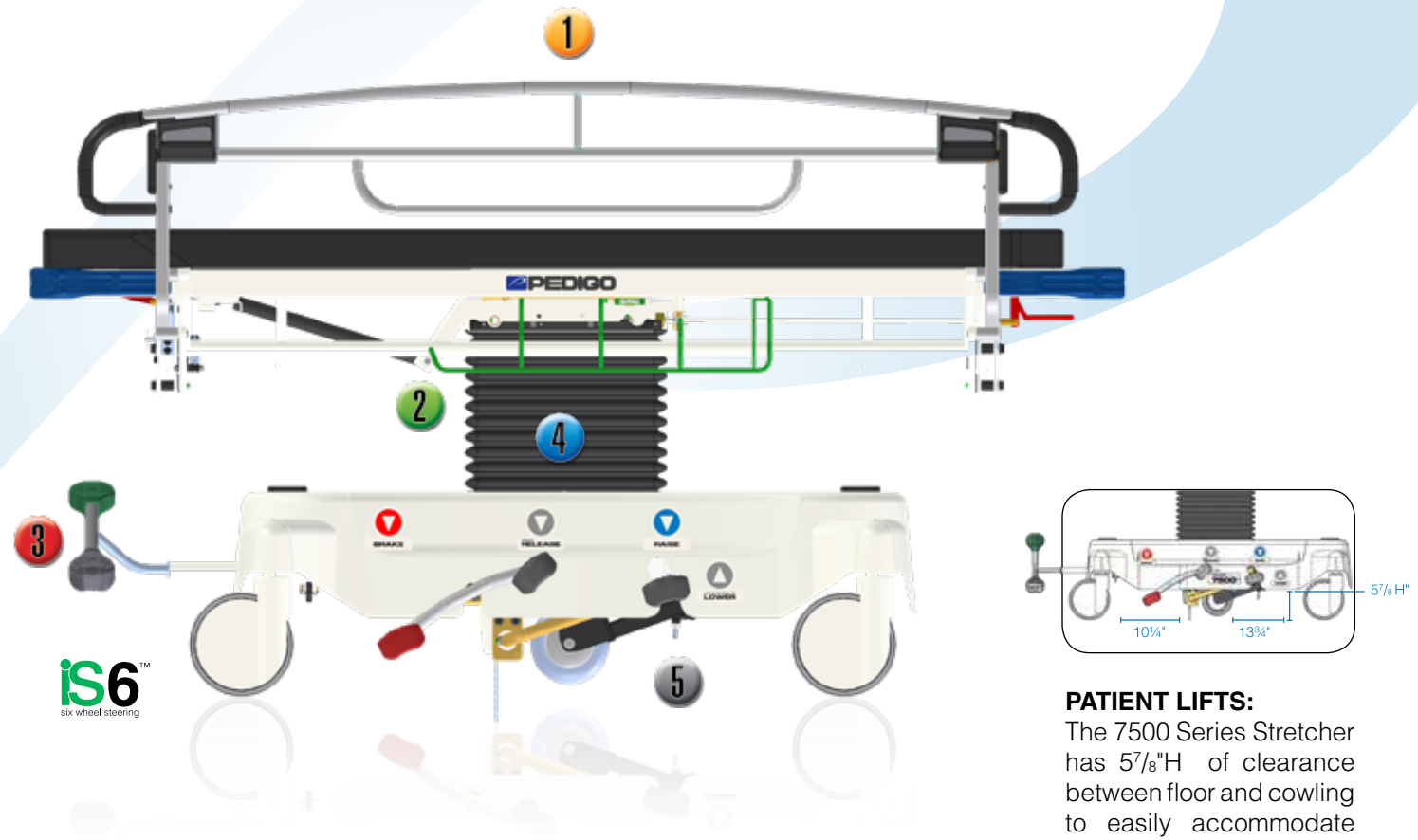

PATIENT LIFTS:
 The 7500 Series Stretcher has 5 7/8" H of clearance between floor and cowling to easily accommodate and utilize patient lifts.



Now as an added protection in the ongoing battle with bacteria, Pedigo offers the option of side rails made from **CuVerro® bactericidal copper alloy**.

Copper is an intrinsic antimicrobial element and **CuVerro®** is the **ONLY** solid touch surface metal registered by the EPA to continuously kill bacteria¹ that cause infections and pose a risk to human health. Lab tests show more than 99.9% of bacteria¹ associated with disease and infection, including MRSA¹, are killed within two hours when in contact with copper. Bacteria will continue to be killed 24 hours a day, week after week, between regular cleanings.

¹ CuVerro® alloys have proven effectiveness on MRSA (Methicillin-Resistant Staphylococcus aureus), Staphylococcus aureus, Enterobacter aerogenes, Pseudomonas aeruginosa, and Escherichia coli 0157:H7 and VRE (Vancomycin-Resistant Enterococcus). CuVerro is a registered trademark of GBC Metals LLC, d/b/a Olin Brass.



7500 Series GUARDIAN Package includes:

- CuVerro® Side Rails
- 7500 Transport Stretcher
- Quick-Release™ O₂ Tank Holder
- 4" Blue Premium Mattress
- **is6** Instant Steer 6th Wheel Steering
- Fold Down IV pole
- IV Caddy

Because stretcher side rails should **protect,** not infect.

